

# Conduit hubs

## CONDUIT HUBS – MALLEABLE IRON

### Applications:

- Ideal for terminating electrical conduit through the walls of enclosures
- Designed for use indoors or outdoors with rigid conduit and IMC; specific applications include: food processing plants, distilleries, breweries, sewage disposal plants, chemical plants, paper processing mills and refineries

### Features:

- Male thread type
- Tapered female thread for rigid conduit and IMC
- Recessed o-ring gasket assures raintight and secure environmental connections
- Insulated throat provides smooth pulling surface
- Locking screw on the nut doubles as a grounding screw for added safety
- Complete size range from 1/2" to 6"
- Hubs fit standard knockouts; no special tools required

### Certifications and compliances:

- UL Standard 514B
- cUL Listed – Certified by UL to CSA Standard C22.2 No. 18
- NEMA: FB-1
- Suitable for wet locations
- RoHS compliant



### Standard material and finish:

- Material – malleable iron
- Finish – zinc electroplate

### Options:

- |                                 |               |
|---------------------------------|---------------|
| <b>Description</b>              | <b>Suffix</b> |
| • Mechanically galvanized ..... | <b>HDG</b>    |

Conduit hubs

| Cat. # | Size   | Unit qty. | Wt. lbs. per 100 | A    | B    | C    |
|--------|--------|-----------|------------------|------|------|------|
| MHUB1  | 1/2"   | 25        | 18               | 1.35 | 1.53 | 1.45 |
| MHUB2  | 3/4"   | 25        | 25               | 1.62 | 1.84 | 1.51 |
| MHUB3  | 1"     | 5         | 50               | 1.81 | 2.06 | 1.79 |
| MHUB4  | 1 1/4" | 5         | 25               | 2.32 | 2.62 | 2.02 |
| MHUB5  | 1 1/2" | 2         | 20               | 2.76 | 3.13 | 2.05 |
| MHUB6  | 2"     | 1         | 10               | 3.15 | 3.58 | 2.14 |
| MHUB7  | 2 1/2" | 1         | 10               | 3.69 | 4.18 | 2.91 |
| MHUB8  | 3"     | 1         | 5                | 4.44 | 5.05 | 3.15 |
| MHUB9  | 3 1/2" | 1         | 5                | 5.11 | 5.82 | 3.21 |
| MHUB10 | 4"     | 1         | 2                | 5.47 | 6.24 | 3.40 |
| MHUB11 | 5"     | 1         | 1                | 6.85 | 7.79 | 3.60 |
| MHUB12 | 6"     | 1         | 1                | 7.83 | 8.92 | 3.78 |

### Dimensions (in inches):

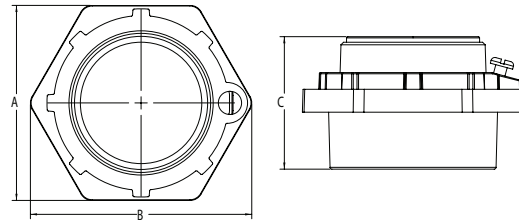

# Conduit hubs

## CONDUIT HUBS – IRON SPACE-SAVER

### Applications:

- Ideal for terminating rigid/IMC conduit through the walls of enclosures
- Designed for use indoors or outdoors with rigid and IMC conduit; specific applications include: food processing plants, distilleries, breweries, sewage disposal plants, chemical plants, paper processing mills and refineries



### Features:

- Male thread is on the nut for a low profile, space saving fit
- Quick and easy when installing rigid conduit nipple between two existing enclosures
- Insulated throat provides smooth pulling surface
- Furnished with SG sealing gasket
- Hub fits standard knockouts; no special tools required

### Standard materials:

- Body and nut – malleable iron
- Sealing ring – steel and rubber

### Standard finishes:

- Body and nut – zinc electroplate
- Sealing ring – natural

### Certifications and compliances:

- UL and cUL Listed, File No. E-19189
- UL Standard 514B
- Certified by UL to CSA Standard C22.2 No. 18
- Suitable for wet locations



Conduit hubs

| Cat. # | Size   | Unit qty. | Wt. lbs. per 100 | A    | B    |
|--------|--------|-----------|------------------|------|------|
| HUB1   | 1/2"   | 25        | 18               | 1.49 | 1.30 |
| HUB2   | 3/4"   | 10        | 25               | 1.44 | 1.54 |
| HUB3   | 1"     | 5         | 50               | 1.57 | 1.78 |
| HUB4   | 1 1/4" | 5         | 25               | 1.98 | 2.16 |
| HUB5   | 1 1/2" | 2         | 20               | 2.00 | 2.37 |
| HUB6   | 2"     | 1         | 10               | 2.19 | 2.93 |
| HUB7   | 2 1/2" | 1         | 10               | 2.61 | 3.56 |
| HUB8   | 3"     | 1         | 5                | 2.81 | 4.18 |
| HUB9   | 3 1/2" | 1         | 5                | 3.02 | 4.64 |
| HUB10  | 4"     | 1         | 2                | 3.65 | 5.21 |

### Dimensions (in inches):

